

representative of completing  
 r and patching work, SLAT  
 re in place to allow traffic flow.

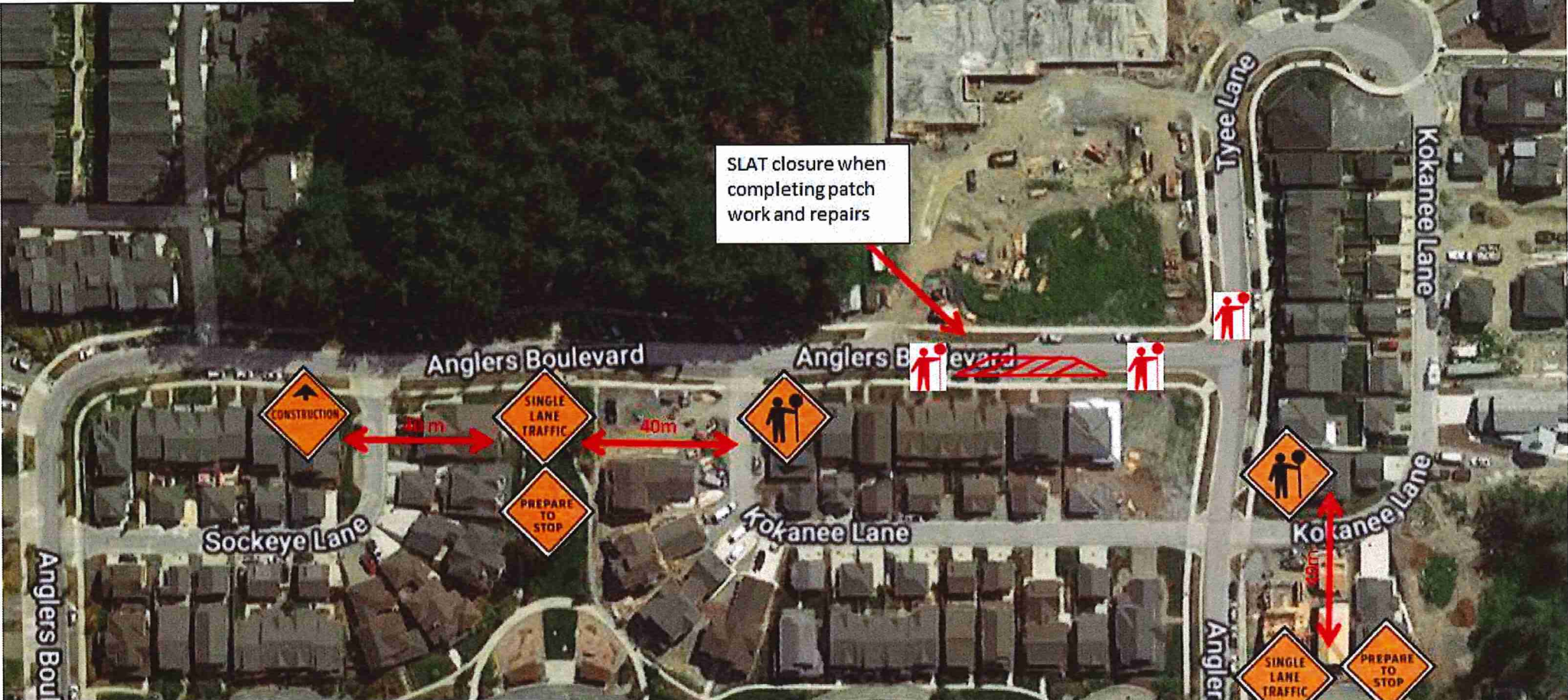

SLAT closure when  
 completing patch  
 work and repairs

01/21/2019 - 02/21/2019  
 Hours of Operation: 7:00 am - 5:00 pm  
 Duration: 1 Month, weather dependent  
 Traffic plan based on a 50 Km speed zone  
 Safety measures to assist pedestrians and cyclists required  
 Lane alignment to be reinstated at the end of each shift  
 Specifications based on the MOT manual for work on roadways  
 Contact: Joe de Melo, (604) 690 9949

**Emergency Vehicles:**  
 Emergency vehicles are obstructed  
 by the SLAT closure. All measures  
 to accommodate emergency  
 vehicles will be put into effect as  
 needed.

**Site Hazards:**  
 The construction area hazards  
 includes the risk of the TCPs  
 controlling traffic.

representative of completing  
 asphalt work, local traffic  
 closure in place to restrict  
 access when milling & surface  
 work.



Start: 01/21/2019 - 02/21/2019  
 Hours of Operation: 7:00 am - 5:00 pm  
 Duration: 1 Month, weather dependent  
 Traffic plan based on a 50 Km speed zone  
 Signs to assist pedestrians and cyclists required  
 Lane alignment to be reinstated at the end of each shift  
 Traffic specifications based on the MOT manual for work on roadways  
 Contact: Joe de Melo, (604) 690 9949

**Emergency Vehicles:**  
 Emergency vehicles are obstructed by the local traffic closure. All measures to accommodate emergency vehicles will be put into effect as needed.

**Site Hazards:**  
 The construction area hazards include the risk of the TCPs controlling traffic. TCPs to be stationed at each local traffic only closure and 1 TCP within the closure.